

# FLOOR PLANS CAPACITY CHARTS

## THE WESTIN

LOMBARD  
YORKTOWN CENTER



# MEETING SPACE OVERVIEW

70 Yorktown Center  
Lombard, Illinois 60148  
T 630.719.8000 F 630.719.8079  
E [westinlombard@starwoodhotels.com](mailto:westinlombard@starwoodhotels.com)  
[westinlombard.com](http://westinlombard.com)

**THE WESTIN**  
LOMBARD  
YORKTOWN CENTER

## LOBBY LEVEL

1. GRAND BALLROOM
2. GRAND BALLROOM FOYER
3. JUNIOR BALLROOM
4. TERRACE
5. JUNIOR BALLROOM FOYER
6. WALNUT
7. MAPLE
8. OAK
9. BOARDROOM
10. LILAC FOYER
11. LILAC
12. CYPRESS
13. MAGNOLIA
14. TANGENT

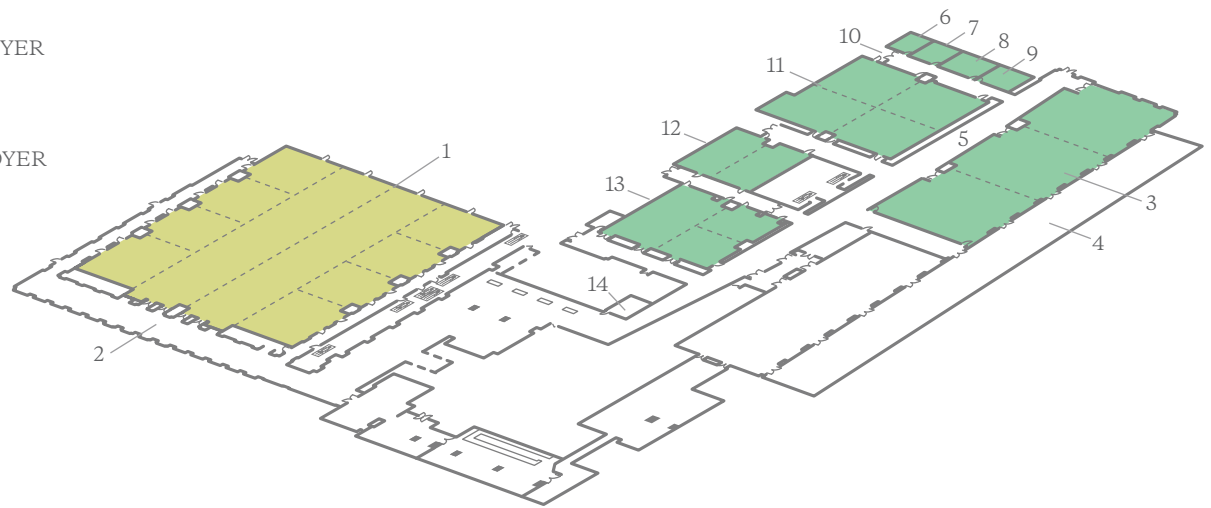

## ROOMS AT A GLANCE

TOTAL GUEST ROOMS	500
TOTAL MEETING ROOMS	26
LARGEST MEETING ROOM CAPACITY	2,500
LARGEST MEETING ROOM SIZE	1,757 m <sup>2</sup> / 18,914 ft <sup>2</sup>

Additional spaces for meetings and events, not displayed here, may also be available. Contact your hotel representative for more information.

# MEETING SPACE LOBBY LEVEL, PART ONE

70 Yorktown Center  
Lombard, Illinois 60148  
T 630.719.8000 F 630.719.8079  
E westinlombard@starwoodhotels.com  
westinlombard.com

## THE WESTIN

LOMBARD  
YORKTOWN CENTER

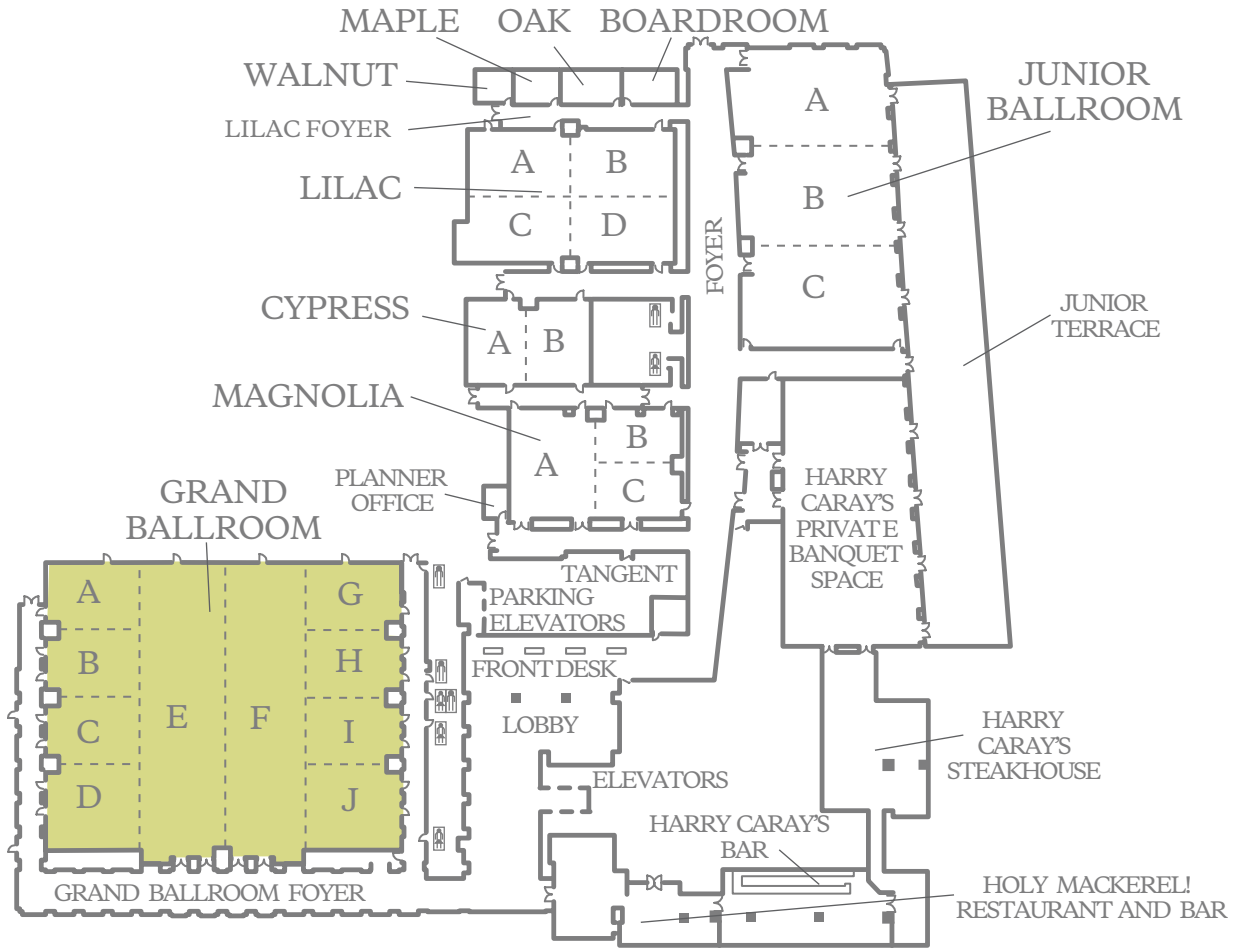

	DIMENSIONS	AREA (SQ. FT.)	MAX CEILING HEIGHT	THEATER	CLASSROOM	BANQUET	CONFERENCE	U-SHAPE	HOLLOW SQ.	RECEPTION
■ GRAND BALLROOM	126' X 148'	18,914	18'	1,960	960	1,420	—	—	—	2,500
GRAND BALLROOM FOYER	23' X 187'	3,475	17.1'	—	—	—	—	—	—	700
■ GRAND A	28' X 38'	1,057	18'	96	60	60	30	33	—	110
■ GRAND A - B	56' X 38'	2,094	18'	208	120	140	48	54	—	210
■ GRAND A - C	84' X 38'	3,135	18'	360	180	210	—	—	—	360
■ GRAND A - D	120' X 38'	4,486	18'	464	216	300	—	—	—	490
■ GRAND A - E	126' X 74'	8,912	18'	952	456	650	—	—	—	960
■ GRAND A - F	126' X 110'	13,359	18'	1,300	780	1,090	—	—	—	1,800
■ GRAND B	28' X 38'	1,037	18'	86	54	50	24	33	—	100
■ GRAND B - C	56' X 38'	2,078	18'	208	120	140	—	—	—	220
■ GRAND B - D	92' X 38'	3,429	18'	336	180	240	—	—	—	390
■ GRAND C	28' X 38'	1,041	18'	96	60	60	30	33	—	100
■ GRAND C - D	64' X 38'	2,392	18'	210	120	180	—	—	—	260
■ GRAND D	36' X 38'	1,351	18'	128	72	90	30	33	—	160

This document contains approximate measurements and square footage that are for illustrative purposes only. We cannot guarantee the floor plan accuracy or completeness, therefore encourage you to review the space to make sure it is suitable for your event.

# MEETING SPACE LOBBY LEVEL, PART TWO

70 Yorktown Center  
Lombard, Illinois 60148  
T 630.719.8000 F 630.719.8079  
E westinlombard@starwoodhotels.com  
westinlombard.com

## THE WESTIN

LOMBARD  
YORKTOWN CENTER

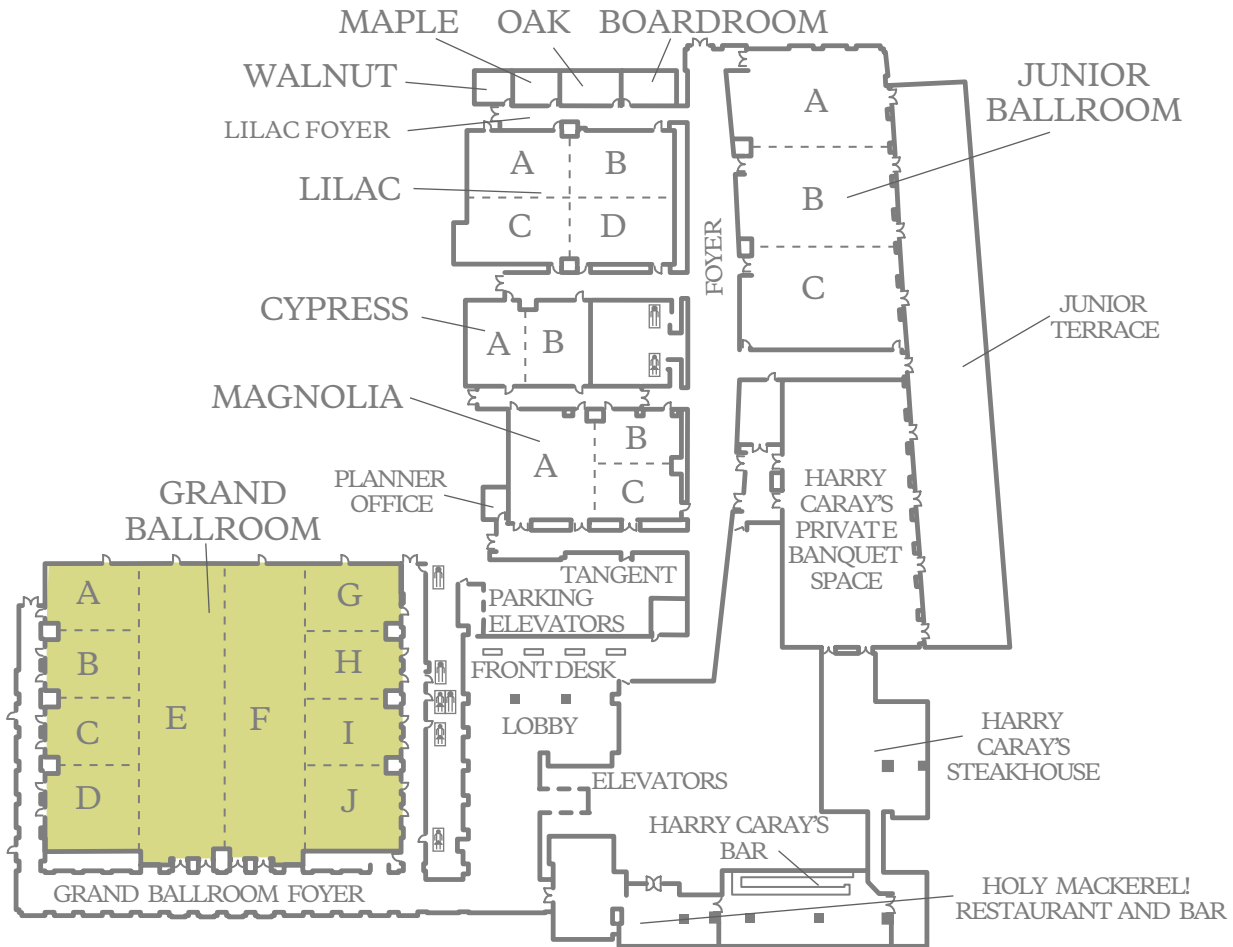

	DIMENSIONS	AREA (SQ. FT.)	MAX CEILING HEIGHT	THEATER	CLASSROOM	BANQUET	CONFERENCE	U-SHAPE	HOLLOW SQ.	RECEPTION
■ GRAND E	126' X 36'	4,426	18'	462	216	330	—	—	—	450
■ GRAND E - F	126' X 72'	8,873	18'	918	456	700	—	—	—	950
■ GRAND E - J	126' X 110'	13,369	18'	1,200	780	1,100	—	—	—	1,800
■ GRAND F	126' X 36'	4,446	18'	464	216	360	—	—	—	450
■ GRAND F - J	126' X 74'	8,943	18'	928	456	660	—	—	—	960
■ GRAND G	28' X 38'	1,059	18'	90	60	60	30	33	—	110
■ GRAND G - H	56' X 38'	2,100	18'	208	120	140	—	—	—	210
■ GRAND G - I	84' X 38'	3,143	18'	360	180	210	—	—	—	360
■ GRAND G - J	120' X 38'	4,497	18'	464	216	300	—	—	—	490
■ GRAND H	28' X 38'	1,042	18'	96	60	60	30	33	—	100
■ GRAND H - I	56' X 38'	2,085	18'	208	120	140	—	—	—	220
■ GRAND H - J	92' X 38'	3,438	18'	336	108	240	—	—	—	390
■ GRAND I	28' X 38'	1,043	18'	96	60	60	30	33	—	100
■ GRAND I - J	64' X 38'	2,396	18'	210	120	170	—	—	—	260
■ GRAND J	36' X 38'	1,353	18'	144	72	90	30	33	—	160

This document contains approximate measurements and square footage that are for illustrative purposes only. We cannot guarantee the floor plan accuracy or completeness, therefore encourage you to review the space to make sure it is suitable for your event.

MEETING SPACE  
LOBBY LEVEL,  
PART THREE

70 Yorktown Center  
Lombard, Illinois 60148  
T 630.719.8000 F 630.719.8079  
E westinlombard@starwoodhotels.com  
westinlombard.com

**THE WESTIN**

LOMBARD  
YORKTOWN CENTER

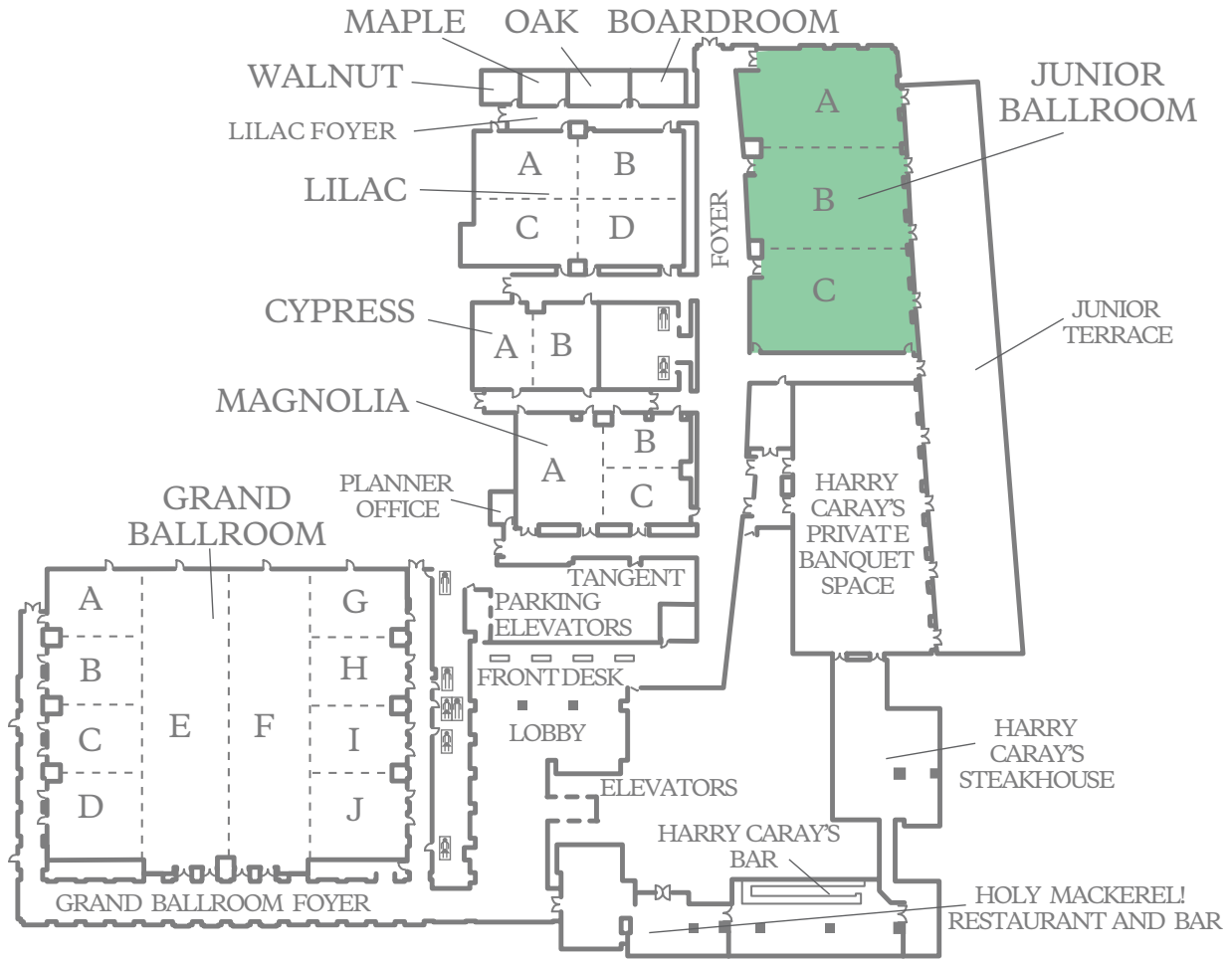

	DIMENSIONS	AREA (SQ. FT.)	MAX CEILING HEIGHT	THEATER	CLASSROOM	BANQUET	CONFERENCE	U-SHAPE	HOLLOW SQ.	RECEPTION
■ JUNIOR BALLROOM	73' X 126'	8,134	15.9'	810	378	600	—	—	—	800
■ JUNIOR A	68' X 42'	2,655	15.9'	280	108	150	48	50	—	260
■ JUNIOR A - B	71' X 85'	5,363	15.9'	500	252	380	—	—	—	525
■ JUNIOR B	68' X 42'	2,708	15.9'	280	108	150	48	50	—	270
■ JUNIOR B - C	70' X 84'	5,479	15.9'	500	252	380	—	—	—	565
■ JUNIOR C	69' X 42'	2,775	15.9'	280	108	150	48	50	—	300
JUNIOR BALLROOM FOYER	16' X 152'	2,432	15.9'	—	—	—	—	—	—	350
JUNIOR TERRACE	18' X 152'	2,736	—	—	—	—	—	—	—	350

This document contains approximate measurements and square footage that are for illustrative purposes only. We cannot guarantee the floor plan accuracy or completeness, therefore encourage you to review the space to make sure it is suitable for your event.



# MEETING SPACE LOBBY LEVEL, PART FOUR

70 Yorktown Center  
Lombard, Illinois 60148  
T 630.719.8000 F 630.719.8079  
E westinlombard@starwoodhotels.com  
westinlombard.com

## THE WESTIN

LOMBARD  
YORKTOWN CENTER

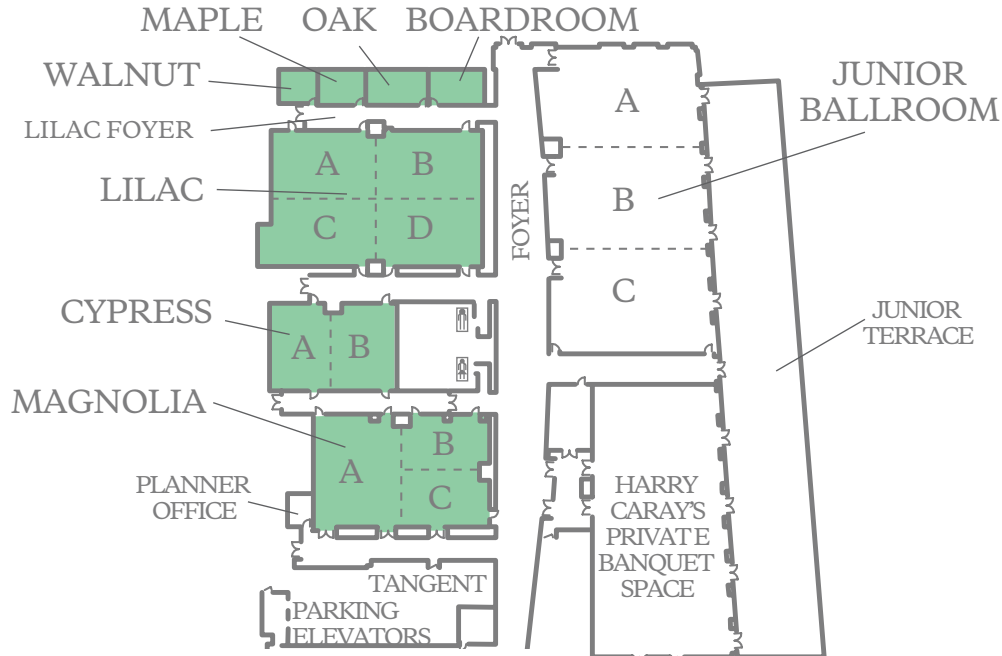

	DIMENSIONS	AREA (SQ. FT.)	MAX CEILING HEIGHT	THEATER	CLASSROOM	BANQUET	CONFERENCE	U-SHAPE	HOLLOW SQ.	RECEPTION
■ BOARDROOM	14' X 21'	294	10'	—	—	—	12	—	—	30
■ CYPRESS	35' X 52'	1,816	9.1'	182	90	120	36	45	—	170
■ CYPRESS A	35' X 26'	907	9.1'	90	45	60	24	24	—	70
■ CYPRESS B	35' X 26'	909	9.1'	90	45	60	24	24	—	70
■ LILAC	56' X 92'	4,917	14'	504	270	400	—	—	—	475
LILAC FOYER	9' X 78'	698	10.9'	—	—	—	—	—	—	—
■ LILAC A	28' X 43'	1,198	14'	108	60	80	30	36	—	100
■ LILAC A & C	56' X 49'	2,491	14'	260	120	200	—	—	—	245
■ LILAC A - B	28' X 86'	2,414	14'	260	126	160	—	—	—	230
■ LILAC B	28' X 44'	1,216	14'	108	60	80	30	36	—	100
■ LILAC B & D	56' X 44'	2,426	14'	260	120	200	—	—	—	235
■ LILAC C	28' X 49'	1,293	14'	110	60	80	30	39	—	125
■ LILAC C - D	28' X 92'	2,503	14'	260	126	160	—	—	—	250
■ LILAC D	28' X 44'	1,211	14'	110	60	80	30	36	—	100
■ MAGNOLIA	47' X 73'	3,232	10.9'	320	180	240	—	—	—	300
■ MAGNOLIA A	47' X 37'	1,641	10.9'	180	84	120	36	33	—	75
■ MAGNOLIA B	24' X 36'	806	10.9'	64	30	50	24	—	—	70
■ MAGNOLIA B - C	47' X 36'	1,586	10.9'	160	84	120	30	—	—	160
■ MAGNOLIA C	23' X 36'	780	10.9'	64	30	50	24	—	—	65
■ MAPLE	14' X 18'	254	10'	20	15	10	10	10	—	20
■ OAK	14' X 26'	360	10'	35	24	20	18	12	—	30
■ WALNUT	14' X 16'	226	10'	20	12	10	8	8	—	15

This document contains approximate measurements and square footage that are for illustrative purposes only. We cannot guarantee the floor plan accuracy or completeness, therefore encourage you to review the space to make sure it is suitable for your event.



70 Yorktown Center  
Lombard, Illinois 60148  
T 630.719.8000 F 630.719.8079  
E [westinlombard@starwoodhotels.com](mailto:westinlombard@starwoodhotels.com)  
[westinlombard.com](http://westinlombard.com)

**THE WESTIN**  
LOMBARD  
YORKTOWN CENTER